

**North Devon Link Road – NDLR – A361
(Portmore to Borners Bridge)
Traffic Bulletin – 06.11.23 - Update**



One Way System - Update

The One-Way diversion that has been operating between Landkey Roundabout and North Aller Roundabout since 11th October will be removed on 11th November and two-way flows will be reinstated on the morning of Saturday 11th November

Traffic Management – Borners Bridge (South Molton)

Please find below updated details of upcoming traffic management at Borners Bridge, South Molton

During night time closures of this area from 12th to 15th November the works will be required to implement the next phase of Borners Bridge junction. Traffic lights will be in place on East St, South Molton during the closures.

Please see diversion maps on page 2 of this bulletin

- Sunday 12th November - 8pm the A361 will be closed between Borners Bridge junction and Bish Mill Roundabout until 6am Monday 13th November. Traffic between North Aller and Bish Mill will be diverted through South Molton as shown in the Diversion below. During this night time works the roads to North Molton and South Molton will remain open.
- Monday 13th November - 8pm the A361 will be closed between North Aller Roundabout and Bish Mill until 6am Tuesday 14th November. During this period please follow the diversions shown below.
- Tuesday 14th November - 8pm Station Road will be closed at Borners Bridge until 6am Wednesday 15th November and there will be traffic lights on the A361 at Borners Bridge. See the diversions below for this period.
- Wednesday 15th November 8pm the A361 will be closed between North Aller Roundabout and Bish Mill until 6am Thursday 16th November. During this period please follow the diversions shown below.

We apologise for any inconvenience and thank you for your patience

Night Closures – Borners Bridge (South Molton)

Day / Date	Start	Finish
Sun: 12.11.23	8pm	Mon: 13.11.23 - 6am
Mon: 13.11.23	8pm	Tue: 14.11.23 - 6am
Tue: 14.11.23	8pm	Wed: 15.11.23 - 6am
Wed: 15.11.23	8pm	Thur: 16.11.23 - 6am

For all Traffic related matters 24/7 call Traffic Safety Control Officer (TSCO)

Tel: 07889 225393*

Your Public Liaison Officer for the NDLR is Lynda Sudlow of Griffiths. She can be contacted:

E: NDLR@alungriffiths.co.uk

T: 0330 041 4637*

Calls are monitored out of normal work hours and a voicemail facility is available.

Please check out our project website : community.alungriffiths.co.uk

If you would like to subscribe to receive future Newsletters and Bulletins, please click [HERE](#) and complete the online form for Mail Chimp. OR use this QR code:



Calls to these numbers are charged at national call rates and included in inclusive minute plans from landlines and mobiles



**North Devon Link Road – NDLR – A361
(Portmore to Borners Bridge)
Traffic Bulletin 06.11.23**



Night Closures – Borners Bridge (South Molton) to Bish Mill – 12.11.23

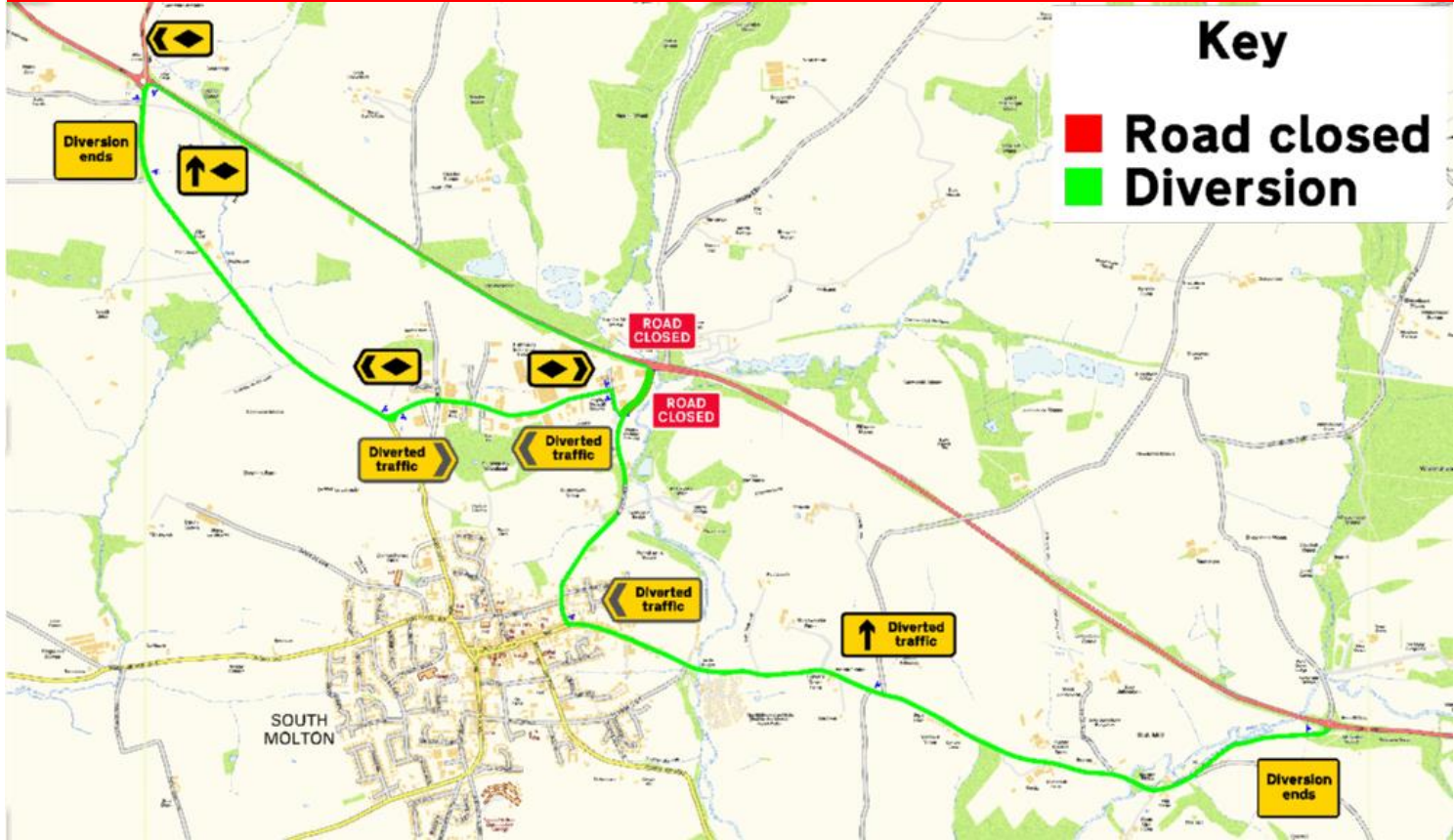

Station Road, South Molton Closed. Traffic lights on A361 – 14.11.23

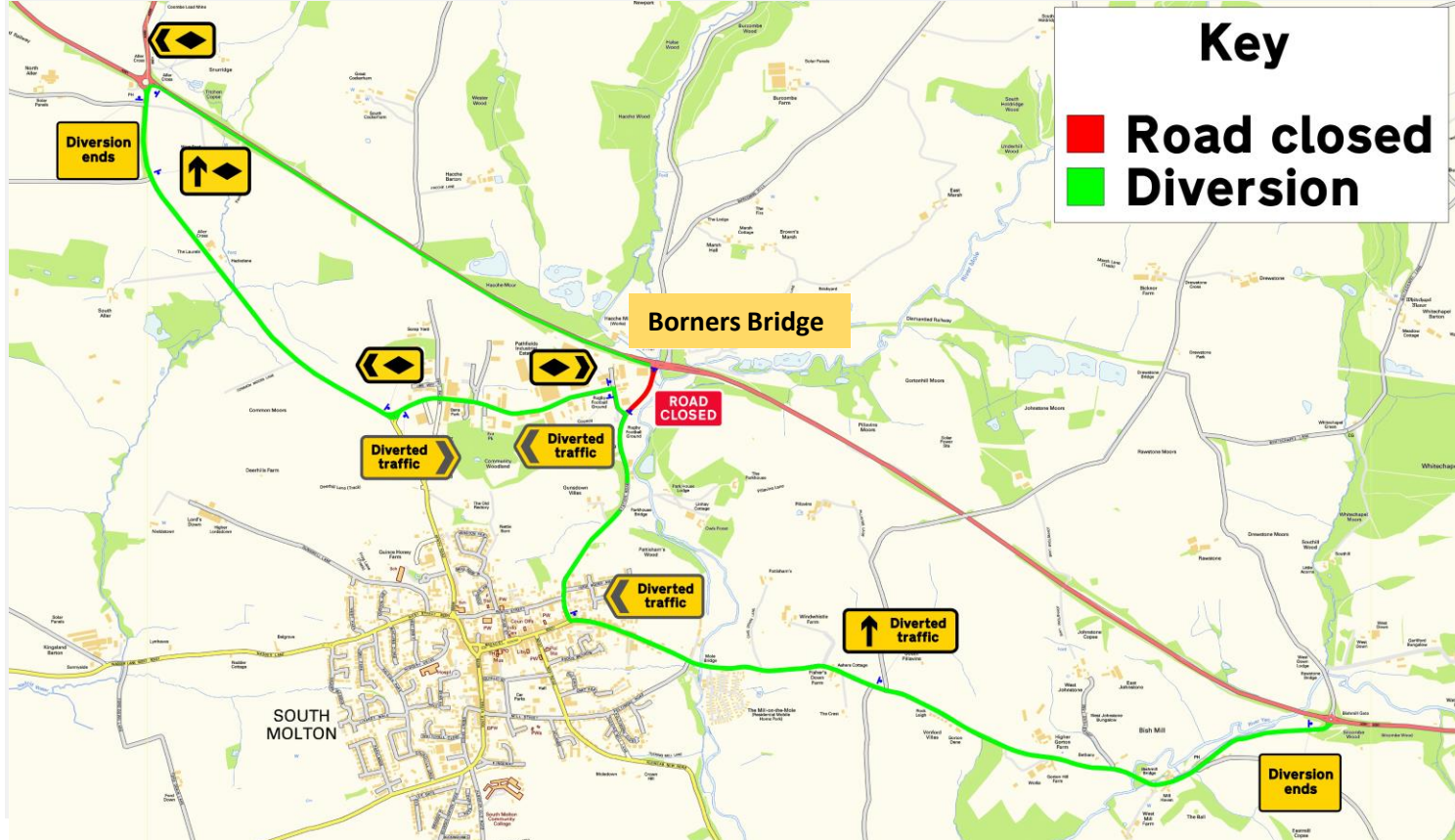

**North Devon Link Road – NDLR – A361
(Portmore to Borners Bridge)
Traffic Bulletin 06.11.23**



**Northern Diversion – Bish Mill Roundabout to North Aller Roundabout - 13.11.23
& 15.11.23**

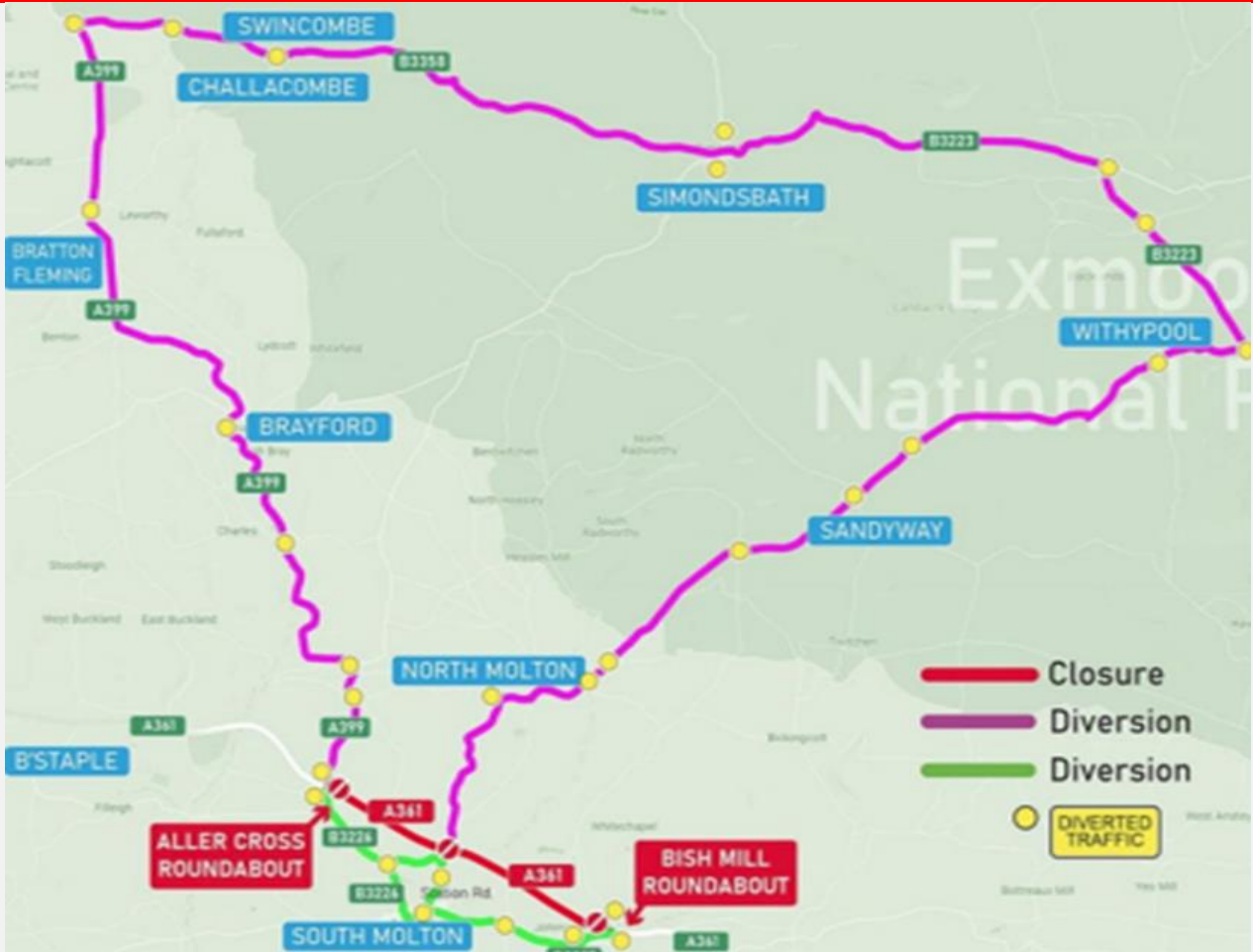

**Southern Diversion - Bish Mill Roundabout to North Aller Roundabout - 13.11.23
& 15.11.23**



**North Devon Link Road – NDLR – A361
(Portmore to Borners Bridge)
Traffic Bulletin 06.11.23**



Night Closures – Landkey Roundabout to North Aller Roundabout

The night time works on the following weeks through November and December will continue as scheduled.

Following the night time closures, works will continue at night under traffic signal control in more isolated areas along the route.

Diversion Map – Landkey Roundabout to North Aller Roundabout

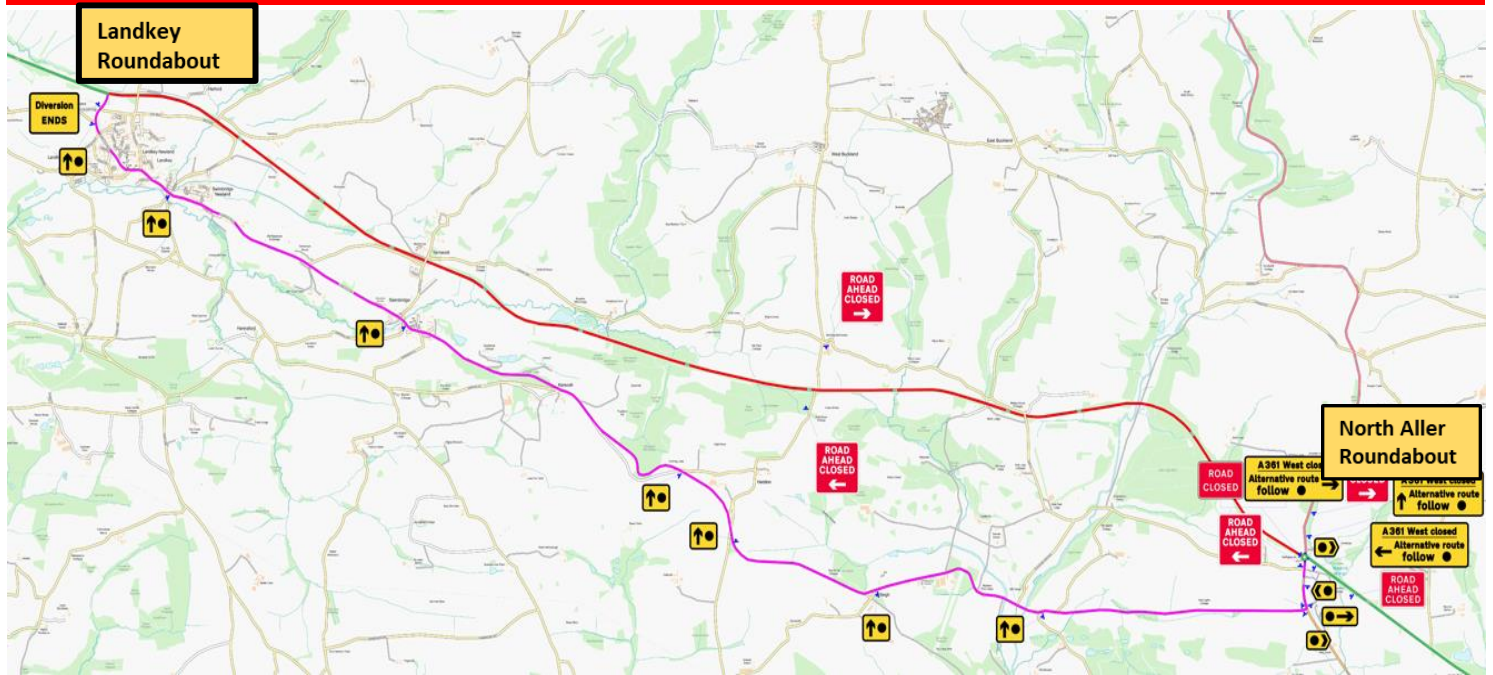

Night Closures – Landkey Roundabout to North Aller Roundabout

Day / Date	Start	Finish
Mon: 20.11.23	8pm	Tue: 21.10.23 - 6am
Tue: 21.11.23	8pm	Wed: 22.11.23 - 6am
Wed: 22.11.23	8pm	Thur: 23.11.23 - 6am
Thur: 23.11.23	8pm	Fri: 24.11.23 - 6am
Fri: 24.11.23	10pm	Sat: 25.11.23- 6am
Mon: 27.11.23	8pm	Tue: 28.11.23 - 6am
Tue: 28.11.23	8pm	Wed: 29.11.23 – 6am
Wed: 29.11.23	8pm	Thur: 30.11.23 - 6am
Thur: 30.11.23	10pm	Fri: 01.12.23 - 6am
Fri: 01.12.23	10pm	Sat: 02.12.23 - 6am

Further Bulletins will be issued regularly to give more details and confirm dates



ABNORMAL LOADS UPDATE – NOVEMBER 2023

This is an extremely busy time for Abnormal Loads using the North Devon Link Road. We are required to manage Abnormal Loads that occasionally must negotiate the A361. These are predominantly large static type caravans due to the tourist nature of this area. Vehicles over 3.5m wide need to be escorted through the works area from Portmore to North Aller Roundabouts.



Griffiths
civil engineering and construction



Devon
County Council

WINTER SEASON

A361 ROADWORKS (NORTH ALLER ROUNDABOUT TO LANDKEY JUNCTION - BOTH DIRECTIONS)

LOADS GREATER THAN 3.5M WIDE WILL BE DISRUPTED WHILST PASSING THROUGH A 7 MILE SECTION OF ROADWORKS - .

TO FACILITATE TRAVEL OF ABNORMAL LOADS THE A361 WILL BE CLOSED AND NORMAL TRAFFIC DIVERTED.

PERMITTED MOVEMENT TIMES THROUGH WORKS

09.30 – 14.30

THESE TIMINGS WILL BE STRICTLY ENFORCED. .

STRICTLY NO NIGHT-TIME/WEEKEND MOVEMENTS ON A361

These instructions are fully supported by Devon and Cornwall Police Abnormal Loads Department and will be strictly enforced.

**Part time closures
may occur for
wide load operations**

**Approximate closure
time of 20 minutes**

There is a national Police policy prohibiting the movement of Abnormal Loads during hours of darkness for safety reasons and we avoid peak traffic hours. The Traffic Safety Control Officer (TSCO) deploys temporary diversion signs so that the oncoming traffic ONLY that would face the Abnormal Load whilst escorted, will be diverted along the diversion route only for the short duration of the load completing its journey through the works area.

We do not receive advance notice of the wide loads diversion. An increase in traffic in one direction could be experienced for up to 20 minutes until the NDLR is again fully opened. We deploy advanced warning signage at this junction, so when this occurs it will be no surprise to local drivers.

We apologise for inconvenience caused and ask you work with us so we can make this procedure work throughout the period it takes to complete this section of work along the A361. For further information, please contact Lynda Sudlow, Public Liaison Officer, North Devon Link Road.

T 0330 041 4637

E: ndlr@alungriffiths.co.uk

*Calls to this number are charged at national call rates and included in inclusive minute plans from landlines and mobiles.